

Preliminary Plat – Variance Request Millwood Townhomes

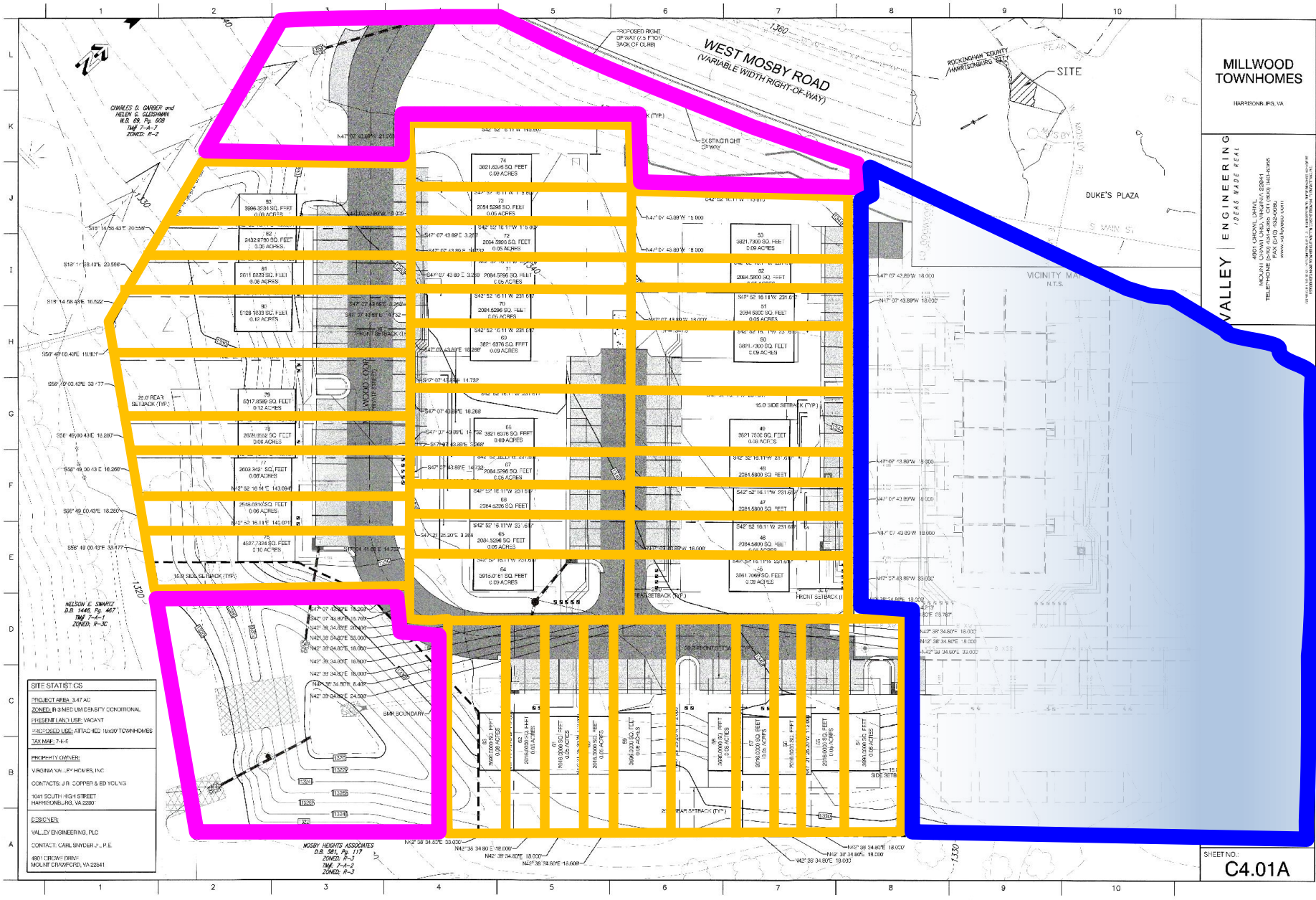





MILLWOOD TOWNHOMES

IRRIPSON, VA

VALLEY ENGINEERING
 IDEAS MADE REAL

4801 GARDEN LANE
 INDEPENDENCE, VIRGINIA 22131
 TELEPHONE: (540) 733-1100
 FAX: (540) 733-1101
 WWW.VALENGR.COM

SITE STATISTICS

TOTAL AREA: 3.47 AC
 ZONED: R-3 MED DENSITY CONDITIONAL
 PRESENT LAND USE: VACANT
 PROPOSED USE: ATTAC 102: 16x40 TOWNHOMES
 TAX MAP: 7-4-1

PRIORITY OWNER:
 VIRGINIA VALLEY HOMES, INC.
 CONTACTS: JIM COPPER & ED VOLINS

1641 SOUTH HICKORY STREET
 HARRISONBURG, VA 22801

DESIGNER:
 VALLEY ENGINEERING, P.C.
 CONTACT: CARL SNYDER, P.E.
 4801 GARDEN LANE
 MOUNT CRAWFORD, VA 22841

SHEET NO:
C4.01A

Recommendation

Staff and Planning Commission (6-0) recommended approval of the preliminary plat and variance as requested.