

Total Fees Due: \$ 455.00 pd.
Application Fee: \$425.00 plus \$30.00 per acre

Date Application & Fee Received: 10-15-19
Received by: ABMKA

Application for Special Use Permit City of Harrisonburg, Virginia

www.harrisonburgva.gov/zoning-applications

Section 1: Description of Property

Location (street address): 1045 Carriage Dr. Harrisonburg, VA 22801
Tax Map Number: Sheet: 96 Block: D Lot: 55 Total Land Area: .25 acres or sq. ft.
Existing Zoning Classification: R 1
Special Use being requested: Short Term Rental

Section 2: Property Owner's Information

Property Owner's Name: Jeannie Marie Turner
Street Address: 1045 Carriage Dr. Email: Franklinlouise5@Hotmail.com
City: Harrisonburg State: VA. Zip: 22801
Telephone: Work: 540-433-0219 Fax: _____ Mobile/Home: 540-433-0219

Section 3: Owner's Representative Information

Owner's Representative: _____
Street Address: _____ Email: _____
City: _____ State: _____ Zip: _____
Telephone: Work: _____ Fax: _____ Mobile/Home: _____

Section 4: Certification

I certify that the information supplied on this application and on the attachments provided (maps and other information) is accurate and true to the best of my knowledge. In addition, I hereby grant permission to the agents and employees of the City of Harrisonburg to enter the above property for the purposes of processing and reviewing this application. I also understand that, when required, public notice signs will be posted by the City on any property.

Signature: Jeannie M. Turner
Property Owner

Section 5: Required Attachments to be provided by Applicant

- Site or Property Map
- Letter explaining Proposed Use & Reasons for Seeking a Special Use Permit
- Traffic Impact Analysis (TIA) Determination Form OR Traffic Impact Analysis (TIA) Acceptance Letter signed by Public Works Department - Applicant is responsible for coordinating with Public Works Department prior to submitting SUP application. More information at www.harrisonburgva.gov/traffic-impact-analysis. This requirement is waived for the following SUPs: major family day homes, reducing required parking areas, reduction in required side yard setback, wireless telecommunication facilities, walls and fences, and short term rentals. To prevent delays in reviewing your application, please consult with Planning staff to confirm your application does not require a TIA Determination Form or TIA Acceptance Letter.

NOTE: If applying for a Wireless Telecommunications Facility allowed only by SUP, then also submit a wireless telecommunications facility application.

Application for Special Use Permit
City Staff and City Council

This letter is to Address the questions Asked about my property, located at 1045 Carriage Drive, Harrisonburg. Originally I finished my basement for my elderly mother to live in but unfortunately She has been placed in a skilled nursing facility because of the level of care she requires. Now I would like to rent that space to help recop some of the money I have invested.

- (A) I, Jeannie M. Turner will be the operator of this short-term rental.
- (B) This is my primary residence.
- (C) I own a small business here in the City. I'm just 8-10 min from my home and will be close by for my guests.
- (D) My Short term rental is a living area in my basement that contains a living room, kitchen area, bedroom, full bath.
- (E) The accommodation has its own private entry way on the lower level of my primary residence.
- (F) I will only accomodate no more than 2 lodgers per night.
- (G) I have 4 off street parking spaces.

Thank You!
Jeannie M. Turner

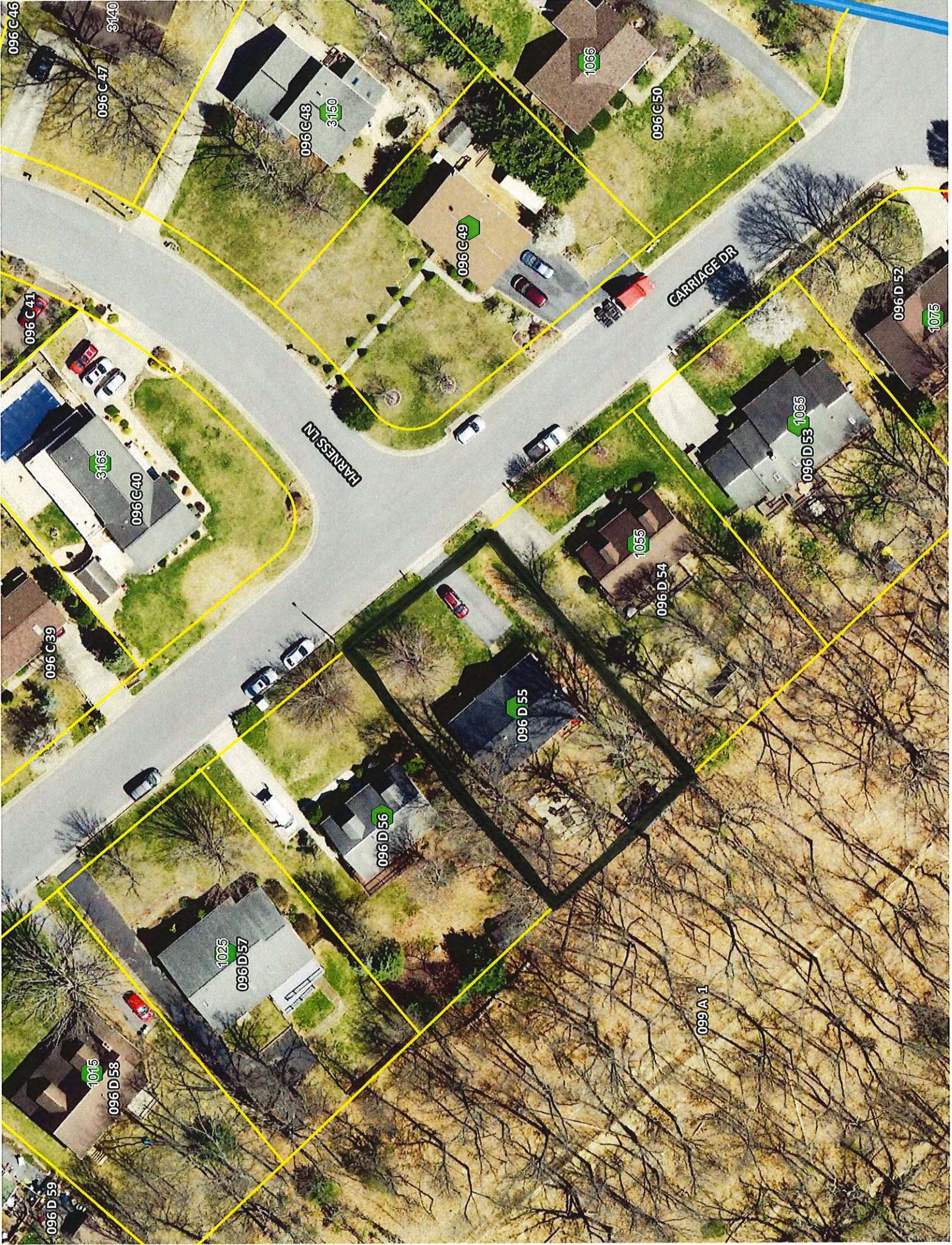

096 C 46

3140

096 C 47

096 C 48

3150

1066

096 C 50

096 C 41

3165

096 C 40

HARNESS LN

096 C 49

CARRIAGE DR

096 D 52

1075

096 D 53

1065

1055

096 D 54

096 D 55

096 D 56

1025

096 D 57

099 A 1

1015

096 D 58

096 D 59