

NOTE: THERE IS NO MINIMUM NUMBER OF PARKING SPACES REQUIRED IN HARRISONBURG'S CENTRAL BUSINESS DISTRICT

ZONE	USE	FLOOR AREA (SF)	SPACES REQUIRED	SPACES PROVIDED	HANDICAP PROVIDED	BIKE PARKING PROVIDED
B1	OFFICE	8,900	-	59	3	8

	AREA (SF)	AREA LANDSCAPING REQUIRED (15% PARKING LOT AREA) (SF)	AREA LANDSCAPING PROVIDED (SF)
PARKING LOT ON PARCEL 35-S-7	8,610	1,292	2,171
PARKING LOT ON PARCEL 35-S-19	8,790	1,319	1,500

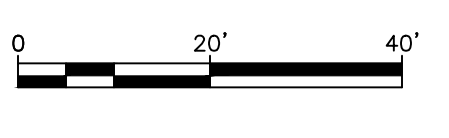
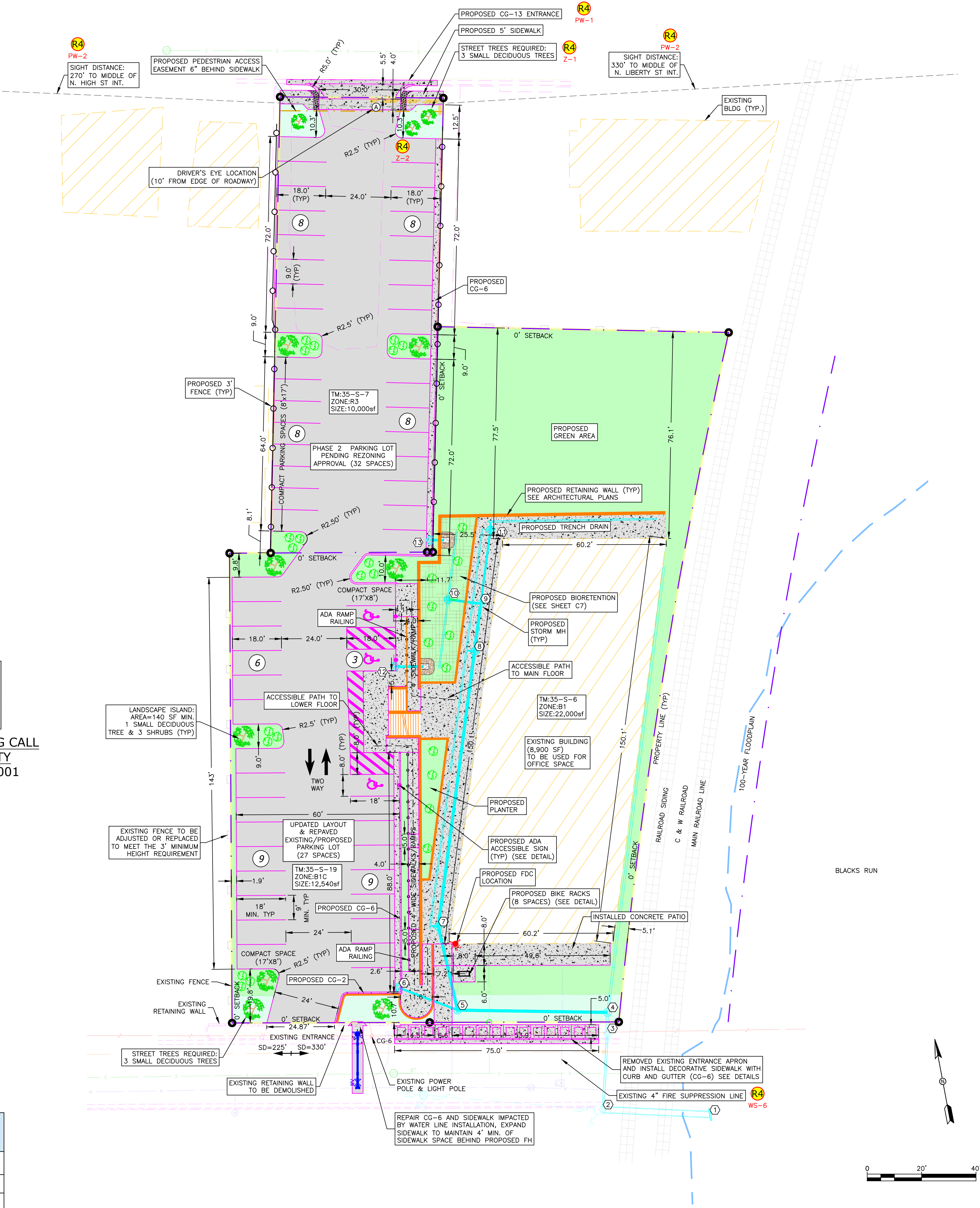

Date: 6/14/2013  
Scale: 1" = 20'  
Designed by: Gil Colman, PE  
Drawn by: Josh Yoder  
Reviewed by: Gil Colman, PE

Revision Dates

R1	7/24/13	Per City Review
R2	8/8/13	Per City Review
R3	5/11/20	Per City Review
R4	6/2/20	Per City Review

**COLMAN ENGINEERING, PLLC**  
1123 South High Street | Harrisonburg, VA 22801 | Ph: (540) 246-3712  
Email: contact@colmanengineering.com | www.colmanengineering.com

GUILLERMO L. COLMAN  
Professional Engineer  
No. 0485716  
6/2/20

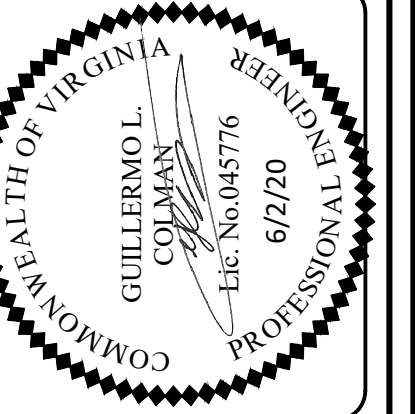

**SITE LAYOUT**  
RENOVATION AT 136 W ELIZABETH ST  
WEST ELIZABETH LLC  
136 West Elizabeth Street  
HARRISONBURG, VA 22802

Project No. CE202031  
Sheet C3  
of 10 Sheets